

# Old Deer Park Study

Conservation Area No.57

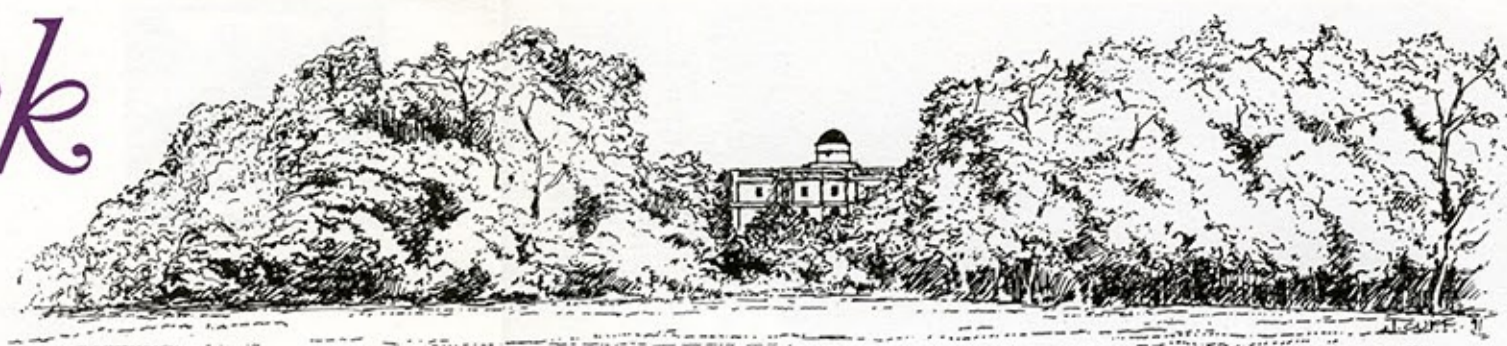

# Proposals



Analysis of the Old Deer Park has identified a large number of opportunities for enhancement and improvement. The proposals are for six distinct areas: the car and lorry park, the recreation ground, the swimming pool, the Richmond Athletic Ground, the London Welsh Rugby Ground and the Golf Course. Proposals are a combination of policies for protection; renovation, improvement and repair projects; and landscaping and enhancement schemes, together with improvements to parking, footpaths and playground facilities.

*- This map and the key summarise the proposals -*

- boundary of Conservation Area
- Listed Building
- PLANTING**
- existing tree planting
- existing avenue planting
- increase sense of enclosure with tree planting
- increase enclosure and reduced visual impact
- existing planting could be improved and softened
- VIEW**
- good views
- potential views
- eyesores
- landmarks

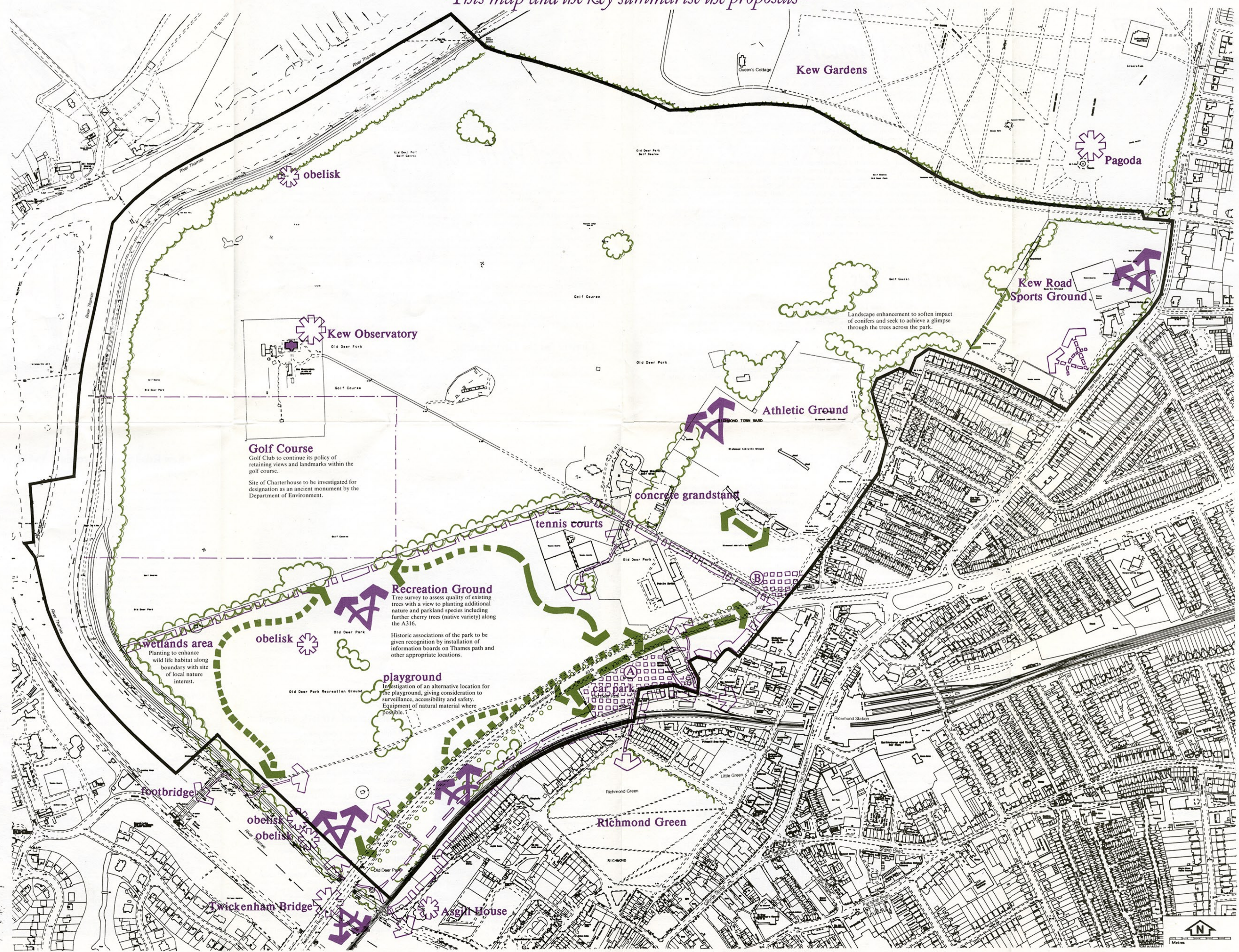

- ACCESS**
- limit of public access
- improved pedestrian links
- site of Shene Charterhouse

- (A)**
    - Car park to be resurfaced providing clearly marked pedestrian routes. Landscape design to be appropriate to parkland setting using advanced nursery stock.
    - Landscaping to reduce visual impact of the car park while allowing a degree of public surveillance.
    - Links between the Town, Richmond Green, the River Thames and the Park to be improved for pedestrians, disabled people and cyclists.
    - Provision of improved boundary fences and rubbish disposal facilities for lessees of premises within the car park.
    - Recycling banks to be relocated and screened. Management procedures to be improved.
  - (B)**
    - Landscape enhancement of access road, rationalisation of boundary fences.
    - Cessation of commuter parking along boundary fence.
    - Improved landscaped parking area for use by spectators.
- Some of these proposals are now being implemented*

